

Nilo

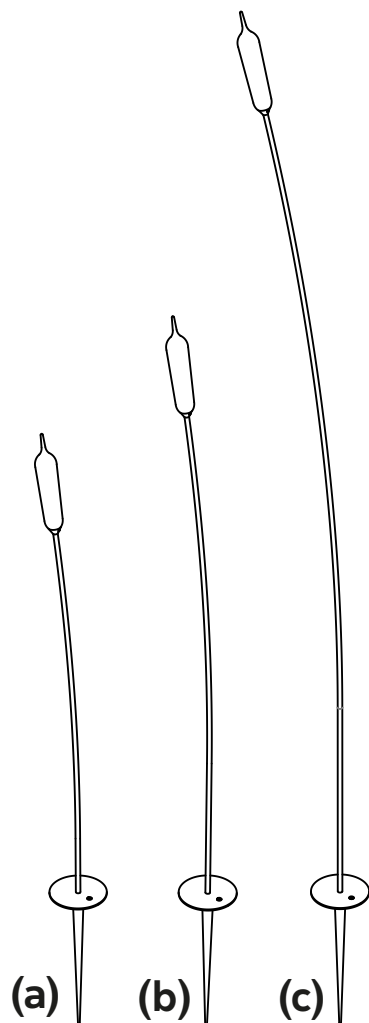

HP211 DN EXT (a)
HP211 EN EXT (b)
HP211 FN EXT (c)

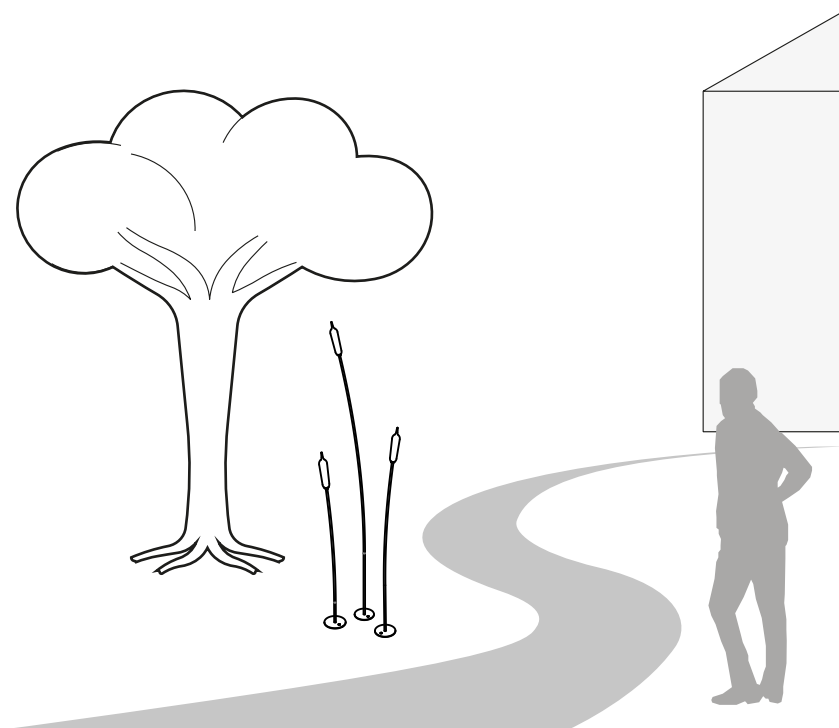

Karman srl

Via A. Grandi, San Martino del piano, 61034 Fossombrone (PU), Italy
p.iva 02175640412 tel +39 0721 71 5042 r.a fax +39 0721 716640 - www.karmanitalia.it

KARMAN

350 mA
led 3,2W

IP65   CE

C - 01



V



x2

P

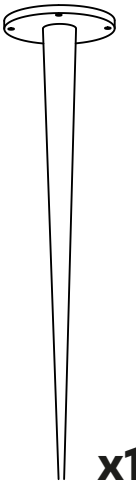

x1

B

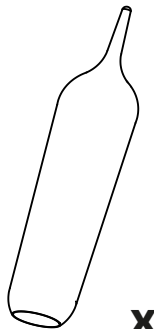

x1

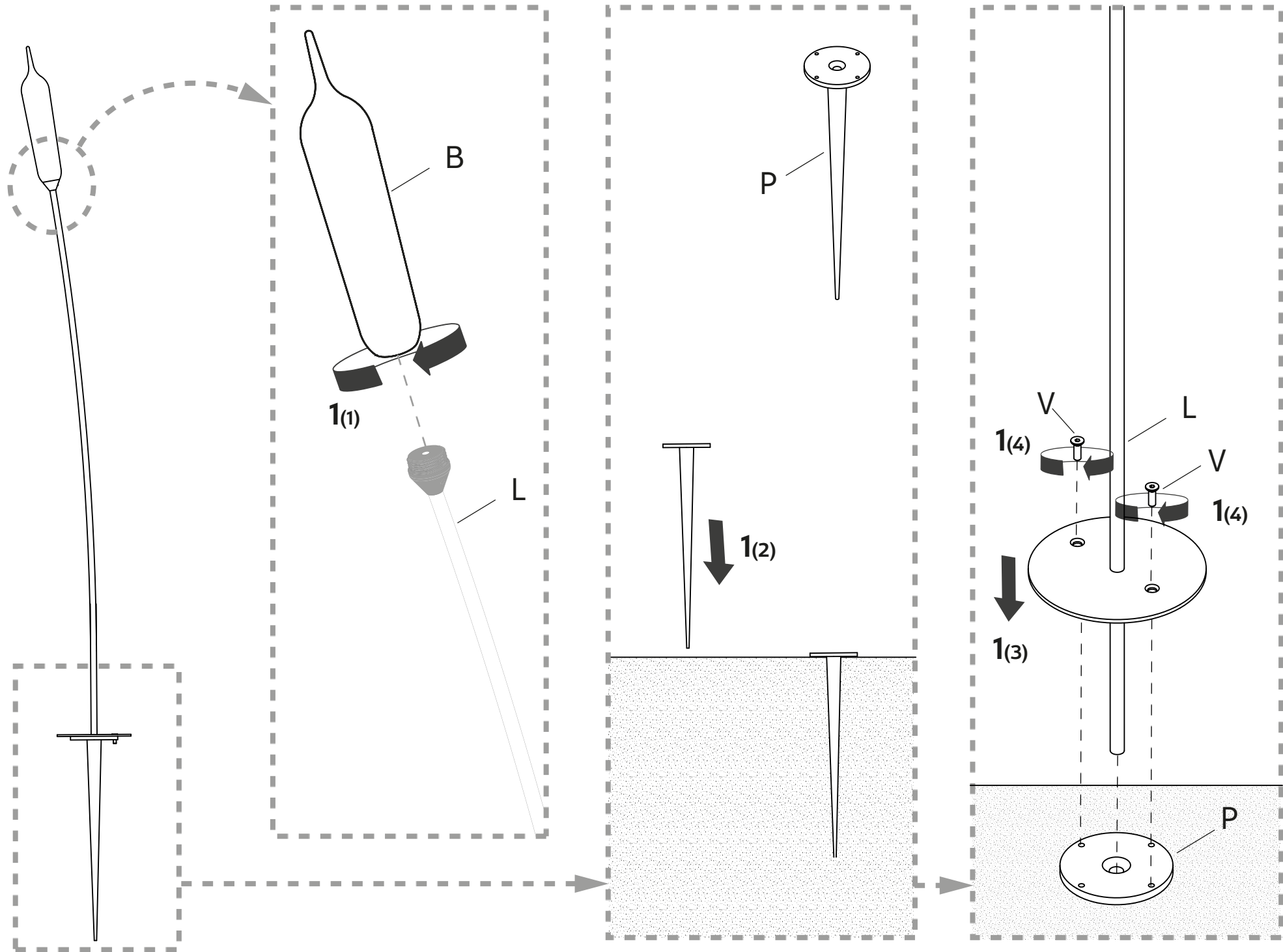

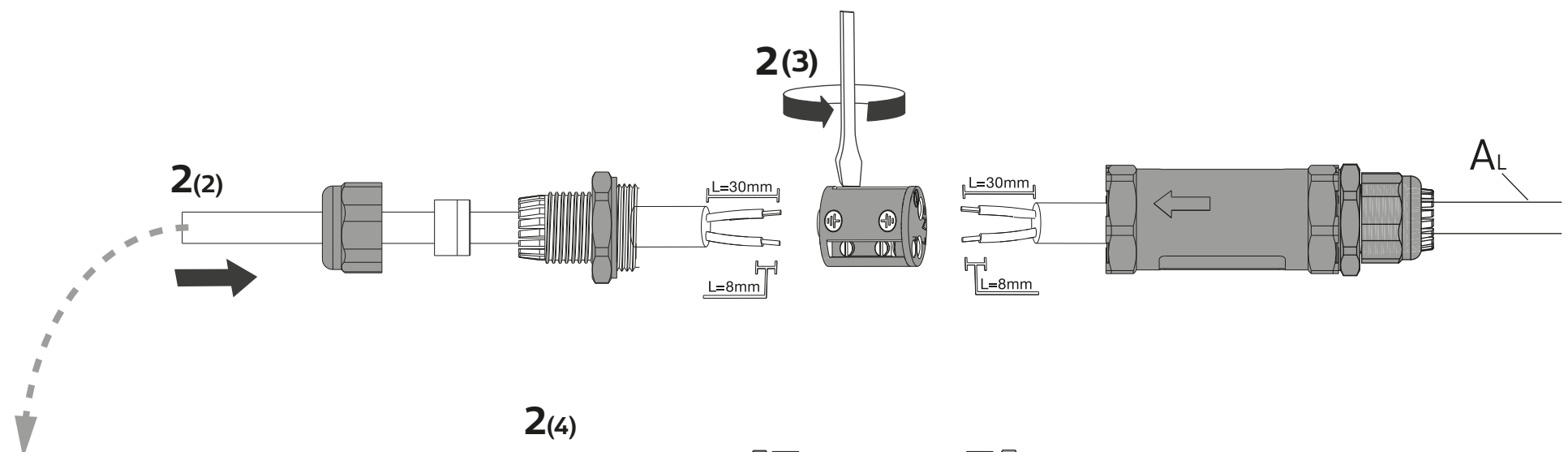
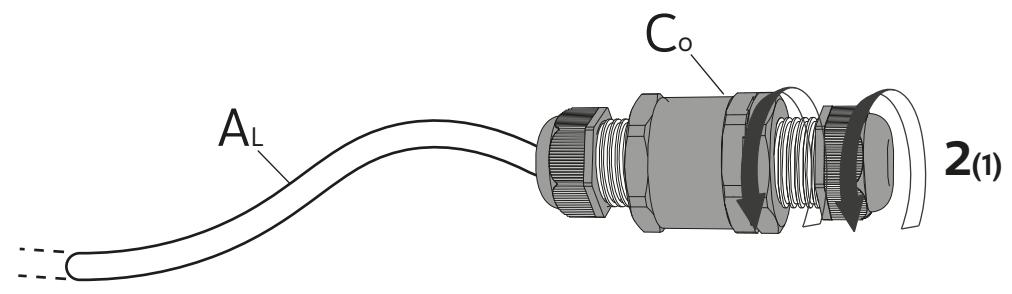
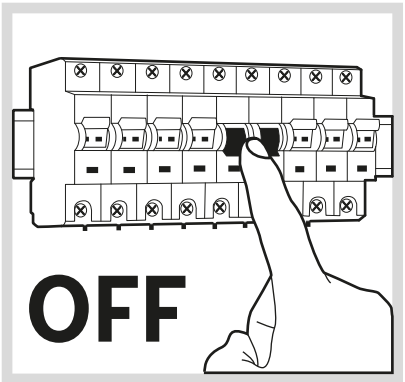

Constant current
350 mA
3,2W

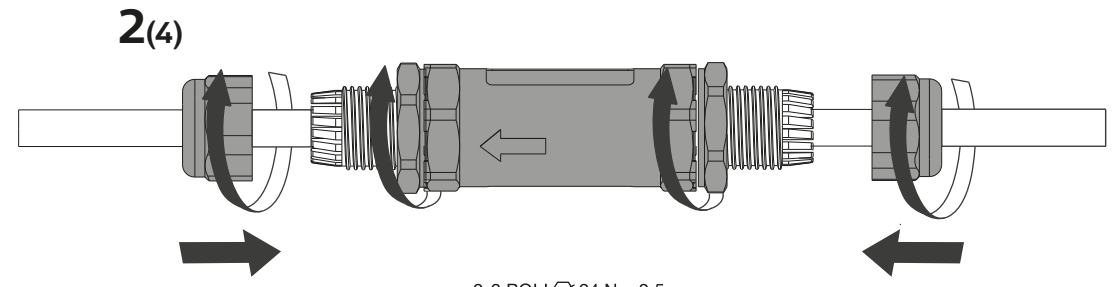

2-3 POLI \varnothing 24 Nm 2.5

